

**AH-80**  
**ASSEMBLY INSTRUCTION**

Wind Loading:  
75 lbs at 50 mph wind  
300 lbs at 100 mph wind

**VERTICAL POLARITY**  
AS SHOWN IN  
DIAGRAM

- ① MOUNTING CLAMP/BOLT X2
- ② 5/8" FLAT WASHER X4
- ③ 5/8" NUT X2
- ④ DISH MOUNTING RING X1
- ⑤ DISH X1
- ⑥ RUBBER WASHER X3
- ⑦ 1/4" DIA. STRUT X3
- ⑧ 1/4" HEX NUT X12
- ⑨ 1/4" FLAT WASHER X6
- ⑩ 1/4" LOCK WASHER X6
- ⑪ ANT. MOUNTING PLATE X1
- ⑫ #4 LOCK WASHER X4
- ⑬ #4 SCREW X4
- ⑭ PATCH ANTENNA X1
- ⑮ ANTENNA CABLE X1
- ⑯ CABLE TIES

FIRST ASSEMBLE THE ① MOUNTING CLAMP/BOLT TO THE ④ DISH MOUNTING RING AND TIGHTEN THE TWO ③ NUTS. THEN ATTACH THE RING ASSEMBLY TO THE ⑤ DISH WITH THE THREE ⑦ STRUTS AND THEIR MOUNTING HARDWARE. PLEASE OBSERVE THE MARKINGS "TOP" ON THE MOUNTING RING, THE DISH AND THE ⑪ ANT. MOUNTING PLATE. DO NOT TIGHTEN THE NUTS UNTIL THE ANT. MOUNTING PLATE IS ALSO ATTACHED. THEN MOUNT THE ⑭ PATCH ANTENNA ACCORDING TO THE POLARITY DESIRED. FINALLY PASS THE ⑮ CABLE THROUGH THE DISH AND SECURE THE CABLE TO THE STRUT WITH CABLE TIES ALLOWING ENOUGH SLACK IN THE CABLE FOR ROTATING THE PATCH ANTENNA IF NEEDED. SEAL THE CONNECTOR JUNCTION FROM WATER ENTRY WITH ELECTRICAL TAPE.

REV. B

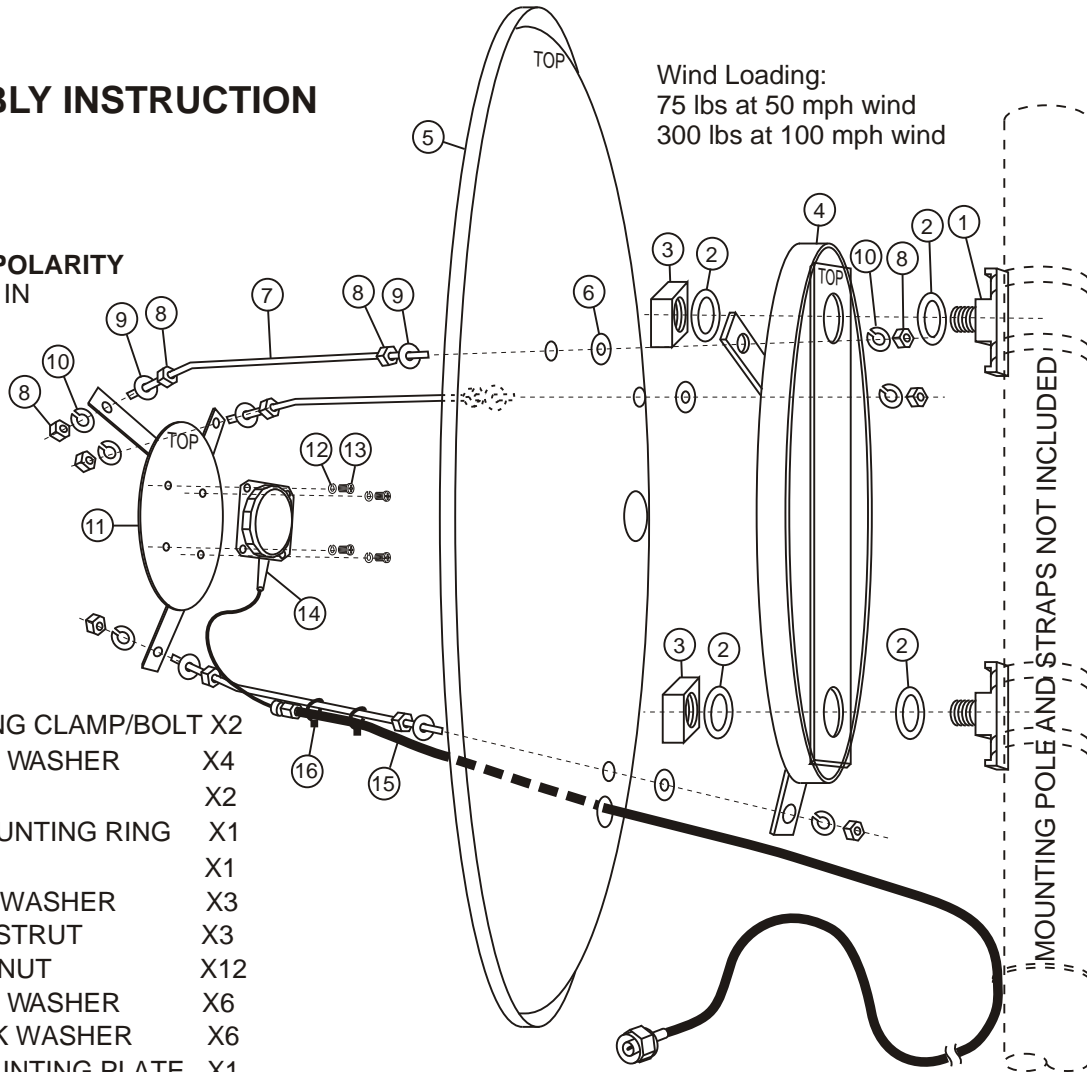

**HORIZONTAL POLARITY**

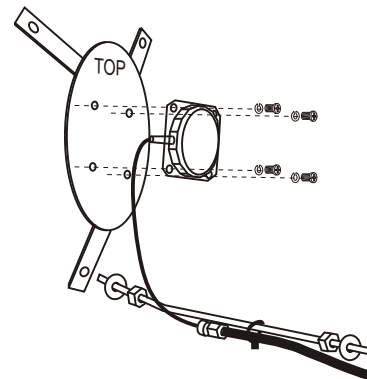

FOR HORIZONTAL POLARITY  
MOUNT THE PATCH ANTENNA  
AS SHOWN